

SUBLEASE RATE REDUCED



5,308 SF INDUSTRIAL BUILDING FOR SUBLEASE

Property Highlights

- Great access to Sherwood Park Freeway, Anthony Henday Drive and 50th Street
- Open warehouse with office build out
- Exterior security roll shutters
- Ample parking and yard space
- Available immediately
- Exposure to busy 76 Avenue



Doug Greschuk

Partner
780 429 9396
doug.greschuk@cwedmonton.com

Chris Van Den Biggelaar

Senior Associate
780 701 3287
chris.biggelaar@cwedmonton.com

Royce Johnson

Associate
780 702 2950
royce.johnson@cwedmonton.com

CUSHMAN & WAKEFIELD

Edmonton
Suite 2700, TD Tower
10088 - 102 Avenue
Edmonton, AB T5J 2Z1
www.cwedmonton.com

PROPERTY DETAILS

Property Type: Office / Warehouse / Yard Storage

Market: Weir Industrial

Yard: Ample yard space

Sublease Rate: \$7.00 per SF \$4.00 per SF

OP Costs: \$5.00± per SF

Sublease Expiry: December 31, 2019

Loading: Dock loading (1.57' above ground)

Ceiling Height: ±14'

FLOOR PLAN

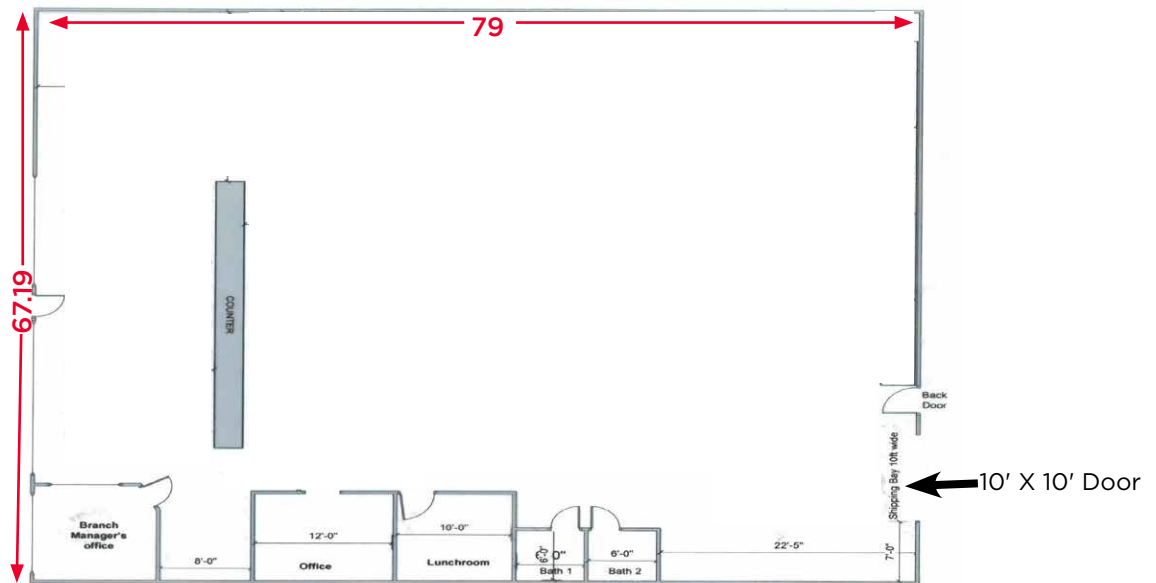

Doug Greschuk

Partner
780 429 9396
doug.greschuk@cwedm.com

Chris Van Den Biggelaar

Senior Associate
780 701 3287
chris.biggelaar@cwedm.com

Royce Johnson

Associate
780 702 2950
royce.johnson@cwedm.com

CUSHMAN & WAKEFIELD

Edmonton
Suite 2700, TD Tower
10088 - 102 Avenue
Edmonton, AB T5J 2Z1
www.cwedm.com