

RETAIL / OFFICE SPACE AVAILABLE

**REDUCED RENTAL RATE!**



**1,181 SQ. FT. RETAIL / OFFICE SPACE**  
**LEASE RATE: \$16.00 PER SQ. FT.**

**Property Features**

- Small retail/office bay available immediately
- Centre located in busy neighbourhood in the South of the city
- Join Tenants: Red Robin, Edmonton Public Library, and Badass Jack's
- Ideal space for optical, flower shops, acupuncturist, orthotics and foot clinics
- Operating Costs: \$13.94 per sq. ft. (2018)  
(Includes natural gas and water, plus electricity and janitorial)
- Sublease Expires: November 30, 2019



**Dustin Bateyko**  
Senior Associate  
780 702 4257  
dustin.bateyko@cwedm.com

**Shane Asbell**  
Partner  
780 917 8346  
shane.asbell@cwedm.com

Suite 2700, TD Tower  
10088 102 Avenue  
Edmonton, AB T5J 2Z1  
[www.cwedm.com](http://www.cwedm.com)

### Property Details

<b>AVAILABLE SPACE:</b>	1,181 sq. ft.
<b>SUBLEASE RATE:</b>	\$16.00 per sq. ft.
<b>OPERATING COSTS:</b>	\$13.94 per sq. ft. (2018) (Includes natural gas and water, plus electricity and janitorial)
<b>PARKING:</b>	First come, first serve
<b>SUBLEASE EXPIRY:</b>	November 30, 2019

### Interior Photos



### Floor Plan

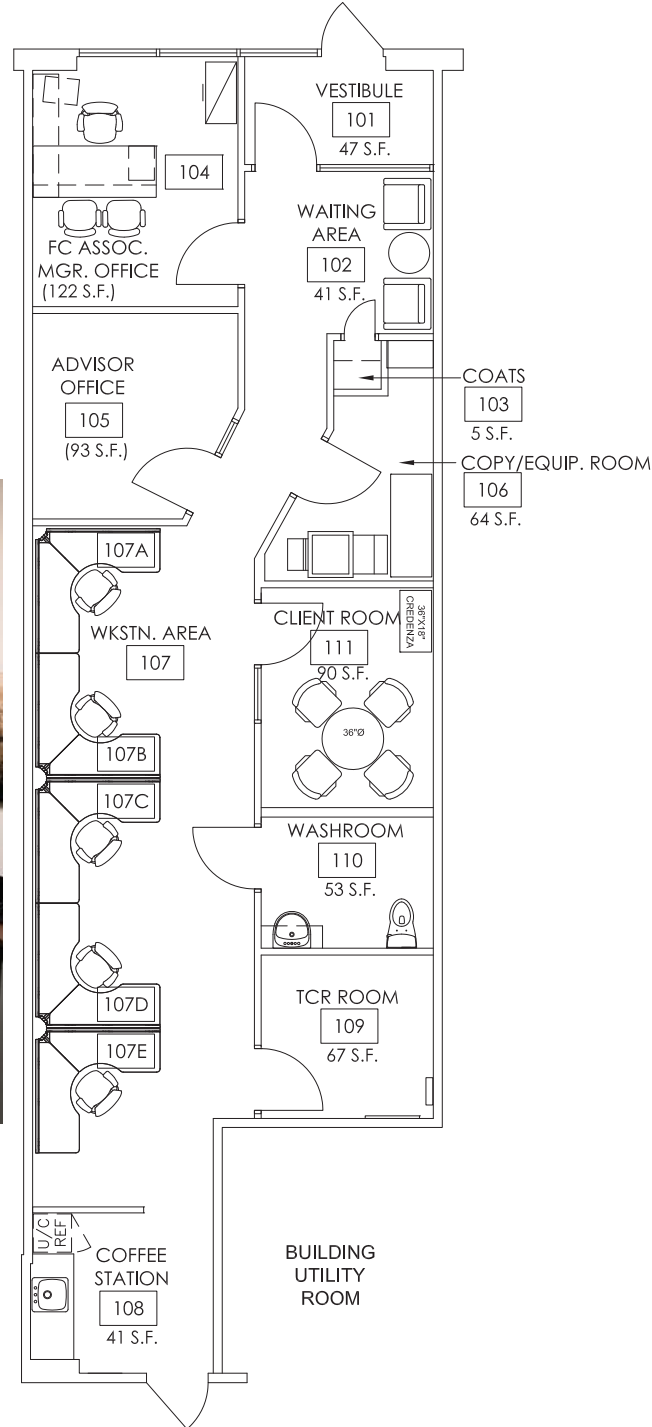

**Dustin Bateyko**  
Senior Associate  
780 702 4257  
dustin.bateyko@cwedm.com

**Shane Asbell**  
Partner  
780 917 8346  
shane.asbell@cwedm.com

Suite 2700, TD Tower  
10088 102 Avenue  
Edmonton, AB T5J 2Z1  
[www.cwedm.com](http://www.cwedm.com)