



FOR LEASE THE EMERALD TOWER

11350 JASPER AVENUE NW, EDMONTON, AB



CONSTRUCTION STARTS FALL 2017



For more information, please contact:

JOHN SHAMEY

Associate

780 702 8079

john.shamey@cwedm.com



Cushman & Wakefield Edmonton
Suite 2700, TD Tower,
10088 – 102 Avenue NW
Edmonton, AB T5J 2Z1
www.cwedm.com

Independently Owned and Operated / A Member of the Cushman & Wakefield Alliance - Cushman & Wakefield Copyright 2017. No warranty or representation, express or implied, is made to the accuracy or completeness of the information contained herein, and same is submitted subject to errors, omissions, change of price, rental or other conditions, withdrawal without notice, and to any special listing conditions imposed by the property owner(s). As applicable, we make no representation as to the condition of the property (or properties) in question. . September 1, 2017

SITE PLAN – MAIN FLOOR RETAIL

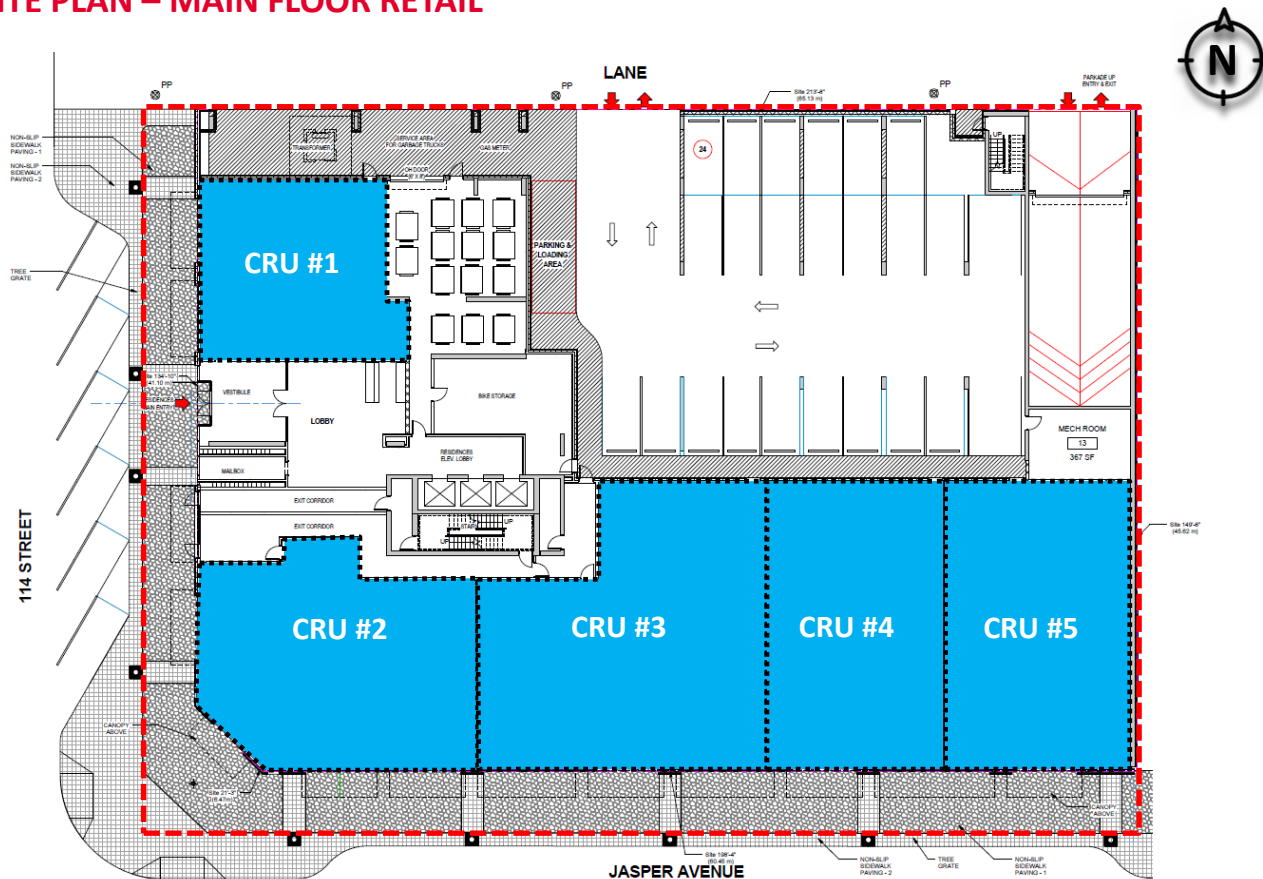

FEATURES			
Vacancy:	CRU #1: 1,541 s.f.	Signage:	Fascia
	CRU #2: 2,662 s.f.	Parking:	3 storeys of above ground parking
Zoning:	CRU #3: 3,560 s.f.	Corridor:	Jasper Avenue
	CRU #4: 2,569 s.f.	Project Status:	Construction starts Fall 2017
Asking Rent:	CRU #5: 2,568 s.f.	Legal Address:	Lot 117/118, Block 13, Plan N
		Traffic Count:	24,600 Vehicles per day
Operating Cost:	\$13.00/s.f. (Est. 2018)	# of Residential Units:	271 Units
Allowance:	Negotiable	# of Storeys:	45 Storeys
Estimated Possession:	Late 2018		



**CUSHMAN &
WAKEFIELD**
Edmonton

FOR LEASE
THE EMERALD TOWER
11350 JASPER AVENUE NW, EDMONTON, AB

MAP

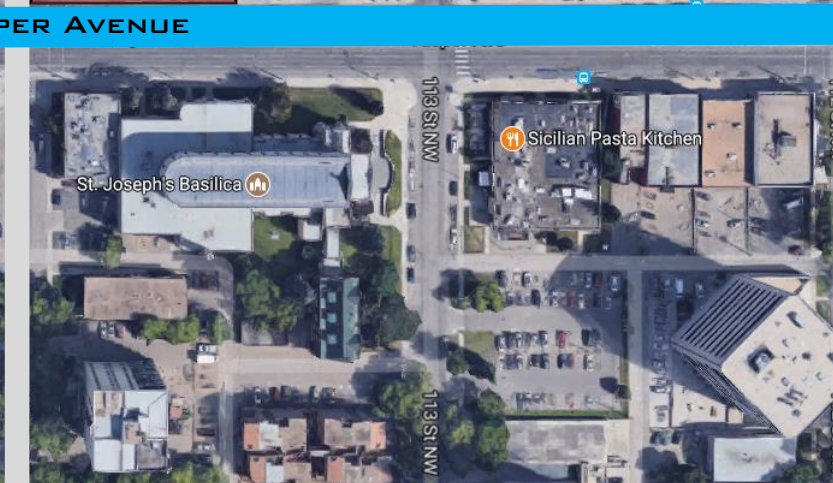
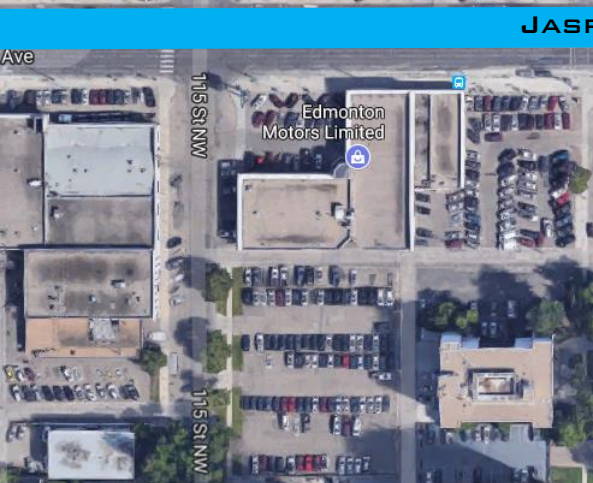

Independently Owned and Operated / A Member of the Cushman & Wakefield Alliance - Cushman & Wakefield Copyright 2017. No warranty or representation, expressed or implied, is made to the accuracy or completeness of the information contained herein, and same is submitted subject to errors, omissions, change of price, rental or other conditions, withdrawal without notice, and to any special listing conditions imposed by the property owner(s). As applicable, we make no representation as to the condition of the property (or properties) in question. . September 1, 2017

FOR LEASE THE EMERALD TOWER

11350 JASPER AVENUE NW, EDMONTON, AB



DEMOGRAPHICS

POPULATION & HOUSEHOLD SUMMARY		
	0 - 3 km	Edmonton
2011 Population (Census)	85,569	844,116
2017 Population Estimate	97,964	976,061
2020 Population Projection	102,946	1,028,564
% Pop. Change (2011-17)	14.5%	15.6%
% Pop. Change (2017-20)	5.1%	5.4%
2017 Families	21,305	276,654
Married couples	11,926	188,196
Common-law couples	5,133	36,145
Lone-parent families	4,245	52,313
Average Persons Per Family	2.4	2.8

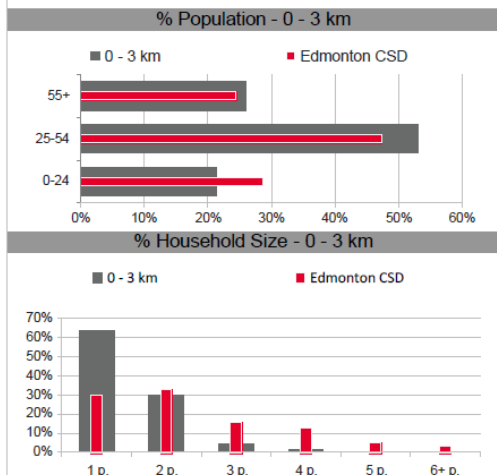

INCOME		
	0 - 3 km	Edmonton
Under \$20K	9,250	42,896
\$20 - \$40K	11,169	52,690
\$40 - \$60K	10,693	54,642
\$60 - \$80K	6,312	42,214
\$80 - \$100K	4,915	44,568
\$100 - \$125K	3,625	42,197
\$125 - \$150K	2,639	34,851
\$150 - \$175K	2,006	25,918
\$175 - \$200K	1,558	19,021
\$200 - \$250K	1,311	14,231
\$250K +	1,748	20,734
Average Household Income	\$ 82,787	\$ 110,315
Median Household Income	\$ 53,122	\$ 82,037

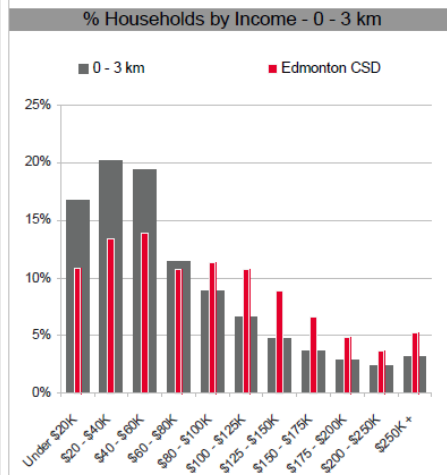

For more information, please contact:

JOHN SHAMEY

Associate

780 702 8079

john.shamey@cwedmonton.com