



**CUSHMAN &
WAKEFIELD**
Edmonton

FOR LEASE

J. E. PLACE II

10548 - 124 Street, Edmonton, Alberta



1,733 SQ. FT. END CAP FOR LEASE

PROPERTY HIGHLIGHTS

J. E. Place II is located in the heart of one of Edmonton's most lively streets and has great exposure on 124th Street. The centre is in close proximity to numerous amenities and is well-suited for a variety of retail, professional and medical uses.

PROPERTY DETAILS

Address:	10548 124 th Street, Edmonton, AB
Legal Description:	Lot 20, Block 30, Plan RN22
Unit Size:	1,733 sq. ft.
Rates:	Market
Operating Costs:	\$10.13 per sq. ft. (2016)
Parking:	Surface parking available
Zoning:	CB1 - Low Intensity Business Zone

Rick Botelho

Associate
780 702 6958
rick.botelho@cwedm.com

Marino Padoan

Senior Associate
780 917 8340
marino.padoan@cwedm.com

LOCATOR MAP



Suite 2700, TD Tower
10088 102 Avenue
Edmonton, AB T5J 2Z1
www.cwedm.com

SITE PLAN

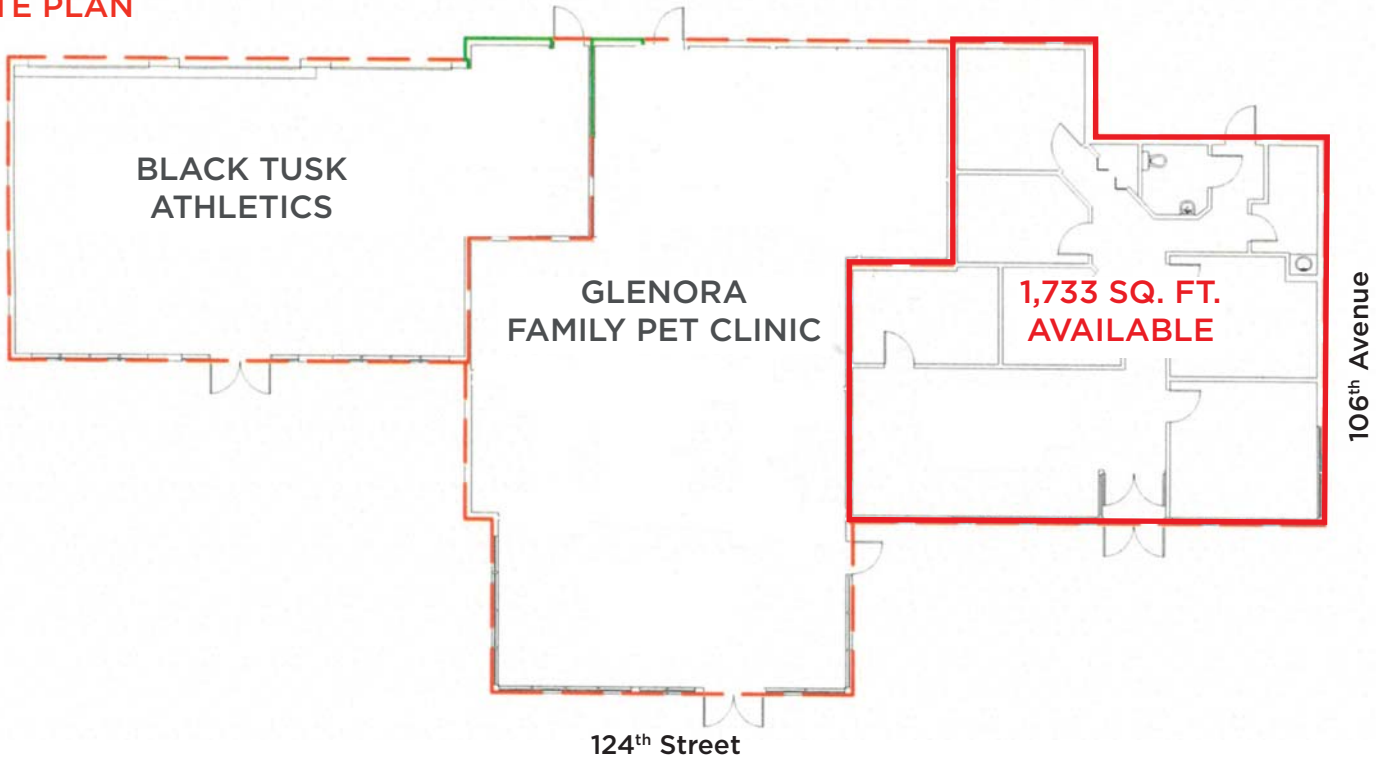

Rick Botelho
Associate
780 702 6958
rick.botelho@cwedm.com

Marino Padoan
Senior Associate
780 917 8340
marino.padoan@cwedm.com

Suite 2700, TD Tower
10088 102 Avenue
Edmonton, AB T5J 2Z1
www.cwedm.com